

Intake Duct

INTAKE (INDUCTION)

5. Intake Duct

A: REMOVAL

- 1) Disconnect the ground cable from battery.
- 2) Remove the intake manifold. <Ref. to FU(STI)-17, REMOVAL, Intake Manifold.>
- 3) Remove the sensor, engine harness and fuel pipe from the intake manifold. <Ref. to FU(STI)-25, DISASSEMBLY, Intake Manifold.>
- 4) Remove the intake duct from intake manifold.

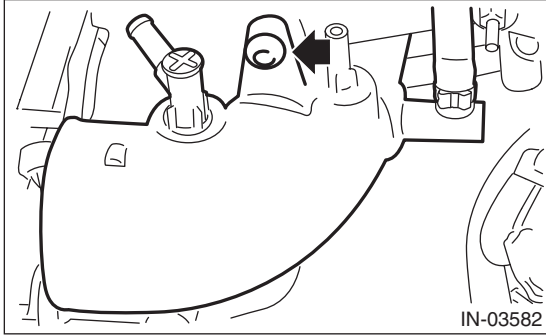

- 5) Remove the PCV hose assembly and air bypass hose from the intake duct.

NOTE:

To disconnect the PCV hose assembly, fit the cut outs of the ST with the protrusions on the clamp as shown in the figure, squeeze the ST's handles together and unlock the clamp.

ST 18353AA000 CLAMP PLIERS

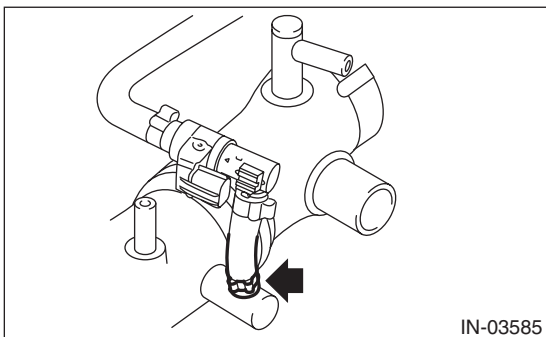
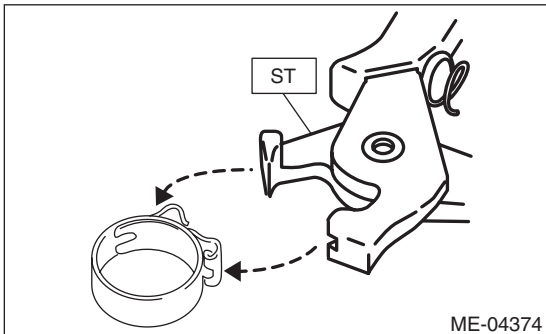

B: INSTALLATION

Install in the reverse order of removal.

NOTE:

Use a new clamp. To connect the PCV hose assembly, fit the cut outs of the ST with the protrusions on the clamp as shown in the figure, squeeze the ST's handles together and lock the clamp.

ST 18353AA000 CLAMP PLIERS

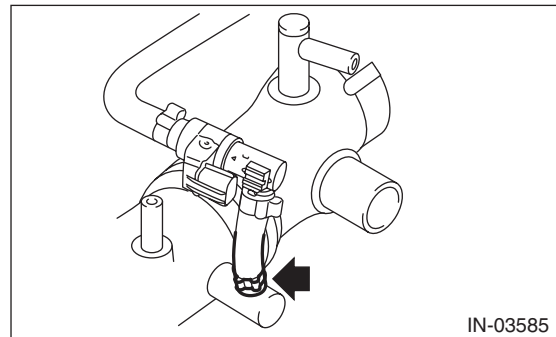
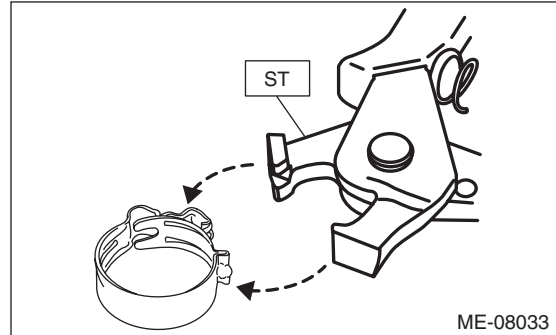

Tightening torque:

17 N·m (1.7 kgf-m, 12.5 ft-lb)

C: INSPECTION

Check that the intake duct has no deformation, cracks or other damages.